

CONTRACTORS SHALL VERIFY ALL DIMENSIONS BEFORE ANY JOB COMMENCES. ALL SHOP DRAWINGS SHALL BE SUBMITTED TO THE SUPERINTENDENT AND MANUFACTURE SHALL NOT COMMENCE PRIOR TO THE RETURN OF UNMARKED SHOP DRAWINGS SIGNED BY THE CONSULTANT. FIGURED DIMENSIONS SHALL TAKE PRECEDENCE OVER SCALED THIS DRAWING SHOULD BE IN CONFORMANCE WITH ALL RELEVANT CONTRACT SPECIFICATIONS AND DRAWING COPYRIGHT OF THIS DRAWING IS VESTED IN WARDLE

General Notes
 1. ALL DIGITAL ARTWORK FILES WILL BE PROVIDED BY ARCHITECT.
 2. CONTRACTORS TO REFER TO RELATED ARCHITECTURAL SPECIFICATION SECTIONS FOR 3D MODEL INTEGRATION REQUIREMENTS.

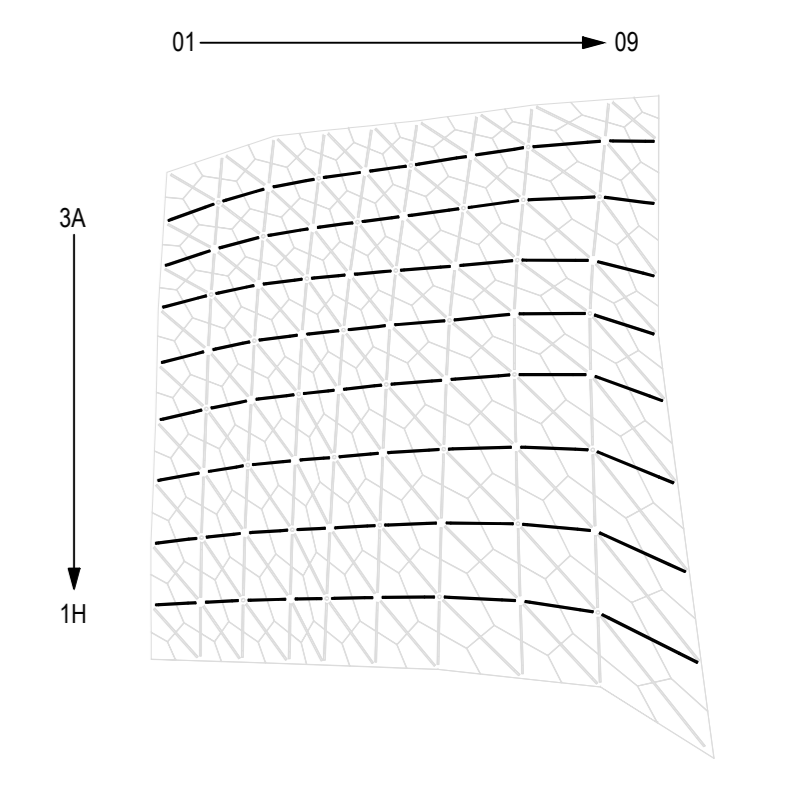
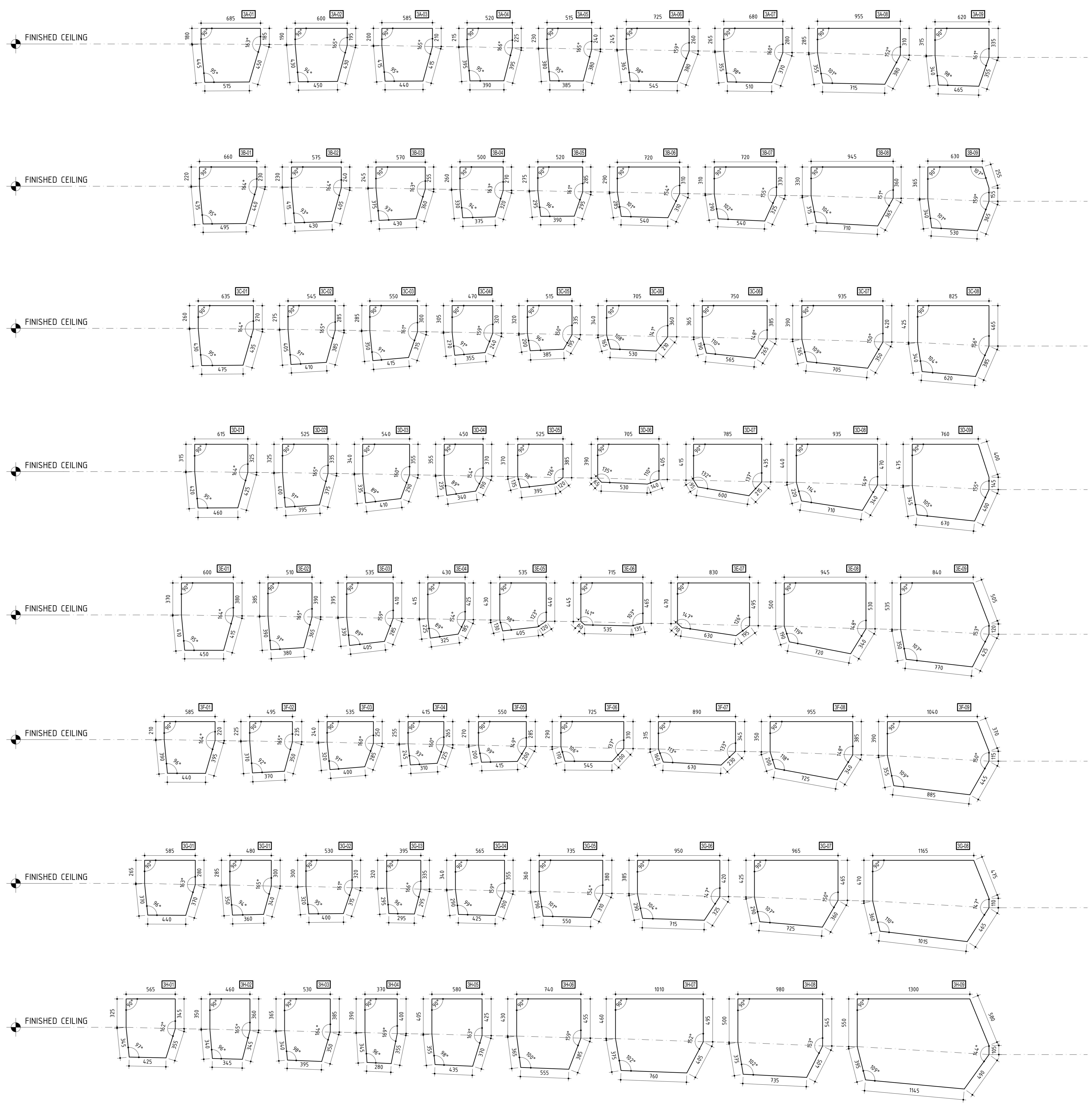

Rev	Issue	Revision Description	Amtd	Date
A	SG	CONSTRUCTION ISSUE	-	06.01.14
04	JC	100% CD - TENDER ISSUE	-	07.06.12
03	JC	90% CD ISSUE	-	10.06.12
02	JC	75% CD ISSUE	-	13.07.12
01	JC	50% CD ISSUE	-	07.06.12

Rev	Issue	Revision Description	Amtd	Date

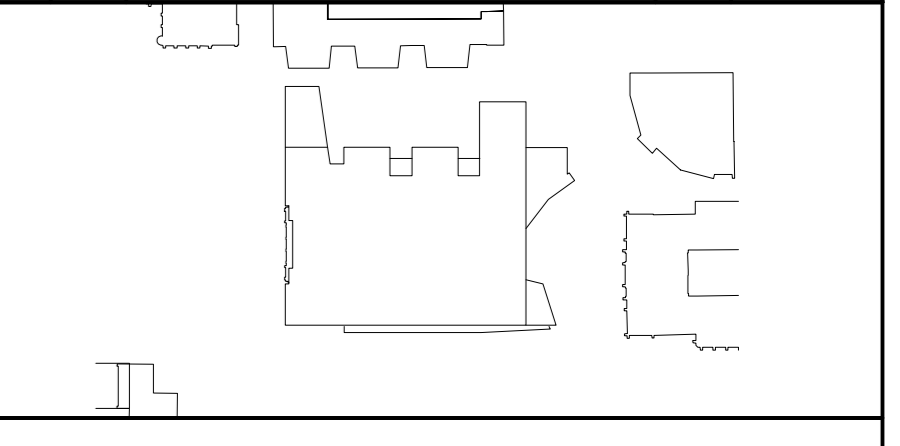

NADAAA
 NADAAA
 1520 Washington Street No 2
 Boston
 Massachusetts
 02118 USA
 Telephone +1 617 442 8332
 Facsimile +1 688 442 1417
 Email nada@nadaaa.com
 nada@nadaaa.com

John Wardle Architects
 © 2011 John Wardle Architects
 Level 10, 180 Russell Street, Melbourne Victoria 3000 Australia
 Tel : +613 9654 8700 www.johnwardlearchitects.com

Client **University of Melbourne
 Parkville Campus**

Project **Faculty of Architecture
 Building and Planning**

Title **HANGING STUDIO
 UNFOLDED SOFFIT**

Project No.	0913	Scale	1:20 @ A0 1:40 @ A2
Drawing No.	AR5126	Revision	A

Date JAN 2014 Dwnr - Csr-Otd - Chk -

FILENAME - ###

FOR CONSTRUCTION

01 HANGING STUDIO - UNFOLDED PANELS
 SCALE 1:20